

Partition wall **Betonwood on metal** **Beton** **Wood**

Building system for partition walls in BetonWood cement bonded particle boards fixed on metal frame

Complete internal insulating wall systems with high performances



| DESCRIPTION

The complete building system for high performances internal wall Partition wall **Betonwood on metal** is easy and quick to install, guarantees maximum comfort and durability over time, with the international ETA certification.

It is the ideal system to realize light partition walls in BetonWood cement bonded particle boards with high mechanical resistance for interanal acoustic insulation of dry systems on metal frame structures.

The building system Partition wall **Betonwood on metal** consists in laying a covering of both sides of the metal frame with panels with high mechanical resistance in BetonWood N cement bonded particle boards.

The stratigraphy consists in **BetonWood N** cement bonded particle boards with high density (1350 kg/m³), an excellent compressive resistance (9.000,00 KPa) and fire resistance (A2 class), CE certified. These panels are fixed with auto-drilling Screws **NF 60** directly on the metal frame structure. Then, these panels can be finished either with a first layer of **BetonAR1** glue-skimming compound, an high density glass fiber net **BetonGlass 360** and a second layer of **BetonAR1** glue-skimming compound, or with a simple plasterboard paneling also fixed by screws.

Advantages

- Approved and secure fixing system.
- Complete system: panels, skimming layers, installation products and accessories
- Easy and quick to install
- Excellent thermal and acoustic insulation (with the addition of insulating panels)
- Fire resistance class A2
- Excellent mechanical resistance against burglary, antivandalism

For more informations about the uses and the installation, our offices are ready to answer your questions on www.betowood.com



STRATIGRAPHY

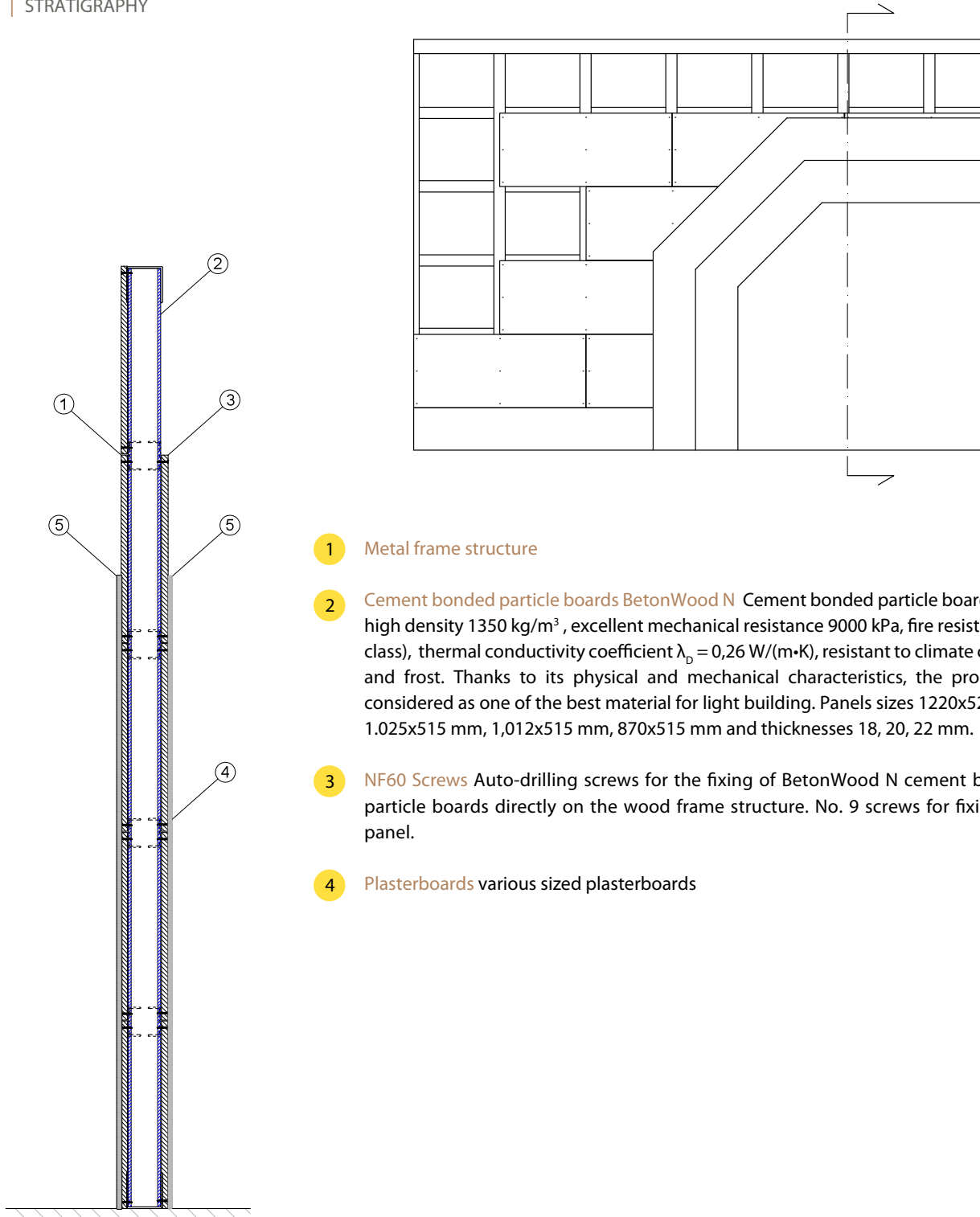

1 Metal frame structure

2 Cement bonded particle boards **BetonWood N** Cement bonded particle boards with high density 1350 kg/m^3 , excellent mechanical resistance 9000 kPa , fire resistant (A2 class), thermal conductivity coefficient $\lambda_D = 0,26 \text{ W/(m}\cdot\text{K)}$, resistant to climate change and frost. Thanks to its physical and mechanical characteristics, the product is considered as one of the best material for light building. Panels sizes $1220 \times 520 \text{ mm}$, $1,025 \times 515 \text{ mm}$, $1,012 \times 515 \text{ mm}$, $870 \times 515 \text{ mm}$ and thicknesses 18, 20, 22 mm.

3 **NF60 Screws** Auto-drilling screws for the fixing of BetonWood N cement bonded particle boards directly on the wood frame structure. No. 9 screws for fixing any panel.

4 **Plasterboards** various sized plasterboards



| SYSTEM'S PRODUCTS



Plasterboards Plasterboards



Screws NF 60 The screw has a special anti-corrosion coating that guarantees a 1,000-hour salt spray resistance. Under-head with very sharp self-sinking fins for a perfect housing of the head flush with the slab. Drill bit that allows a perfect drilling capacity even on high sheet thicknesses.



BetonWood N The BetonWood N cement bonded particle boards, with high density (1350 Kg/m³), made of Portland-type cement conglomerate and debarked Pine wood fiber. These panels have the following thermo-dynamics characteristics: thermal conductivity coefficient $\lambda=0,26$ W/mK, specific heat $c=1,88$ KJ/Kg K, coefficient of resistance to vapor penetration $\mu=22,6$ and reaction to fire class A2-fl-s1, according to the standard EN 13501-1.

BETONWOOD Srl

Head office :
Via Falcone e Borsellino, 58
I-50013 Campi Bisenzio (FI)

T: +39 055 8953144
F: +39 055 4640609

info@betonwood.com
www.betonwood.com

TBTWM - ST R.18.5

| CERTIFICATIONS

The insulation system for internal walls Partition wall Betonwood on metal is made with CE certified materials in accordance with current regulations.

The certificates of the individual products are available on request.

Beton  **Wood**

